

WD254 X-Ray Protective Screen

MAVIG



WD254 folded

- WD2541B** Foldable protective screen with window and a lead equivalence value of Pb 1.00 mm
- WD2542B** Foldable protective screen with window and a lead equivalence value of Pb 2.00 mm

CE
Made in Germany

WD254 – X-Ray Protective Screen

This classic model combines upper and lower body as well as side protection in one single mobile system.

The shield is made of a center main section with two foldable side walls, which can be positioned in any angle from 60° - 120°. A 30 x 40 cm lead glass, observation window has been integrated into the center of the shield. Due to its smooth rolling casters, the shield can be conveniently and easily moved.

The shield is composed of an outer plastic laminated wood in RAL 9002 and is inner lined with lead sheeting. MAVIG offers the mobile shield WD254 in two different lead equivalent values depending on your needs.

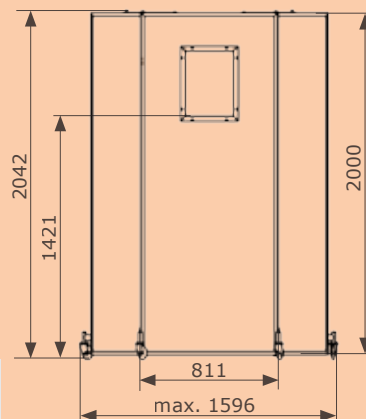

Dimensions Protective Screen with Lead Glass Window

Article No.	Middle Wall (W x H)	Side Walls (W x H)	Lead Equivalent
WD2541B	80 x 200 cm, with window 30 x 40 cm	each 60 x 200 cm	Pb 1.00 mm
WD2542B	80 x 200 cm, with window 30 x 40 cm	each 60 x 200 cm	Pb 2.00 mm

MAVIG GmbH
X-Ray Protection and
Medical Suspension Systems

Stahlgruberring 5
81829 Munich
Germany

PO Box 82 03 62
81803 Munich
Germany

Phone: +49 (0) 89 420 96 - 0
Fax: +49 (0) 89 420 96 - 200
e-Mail: info@mavig.com

www.mavig.com